

Appendices for 61F Lord Avenue (11/0719/COU)
Appendix 1- LOCATION PLAN

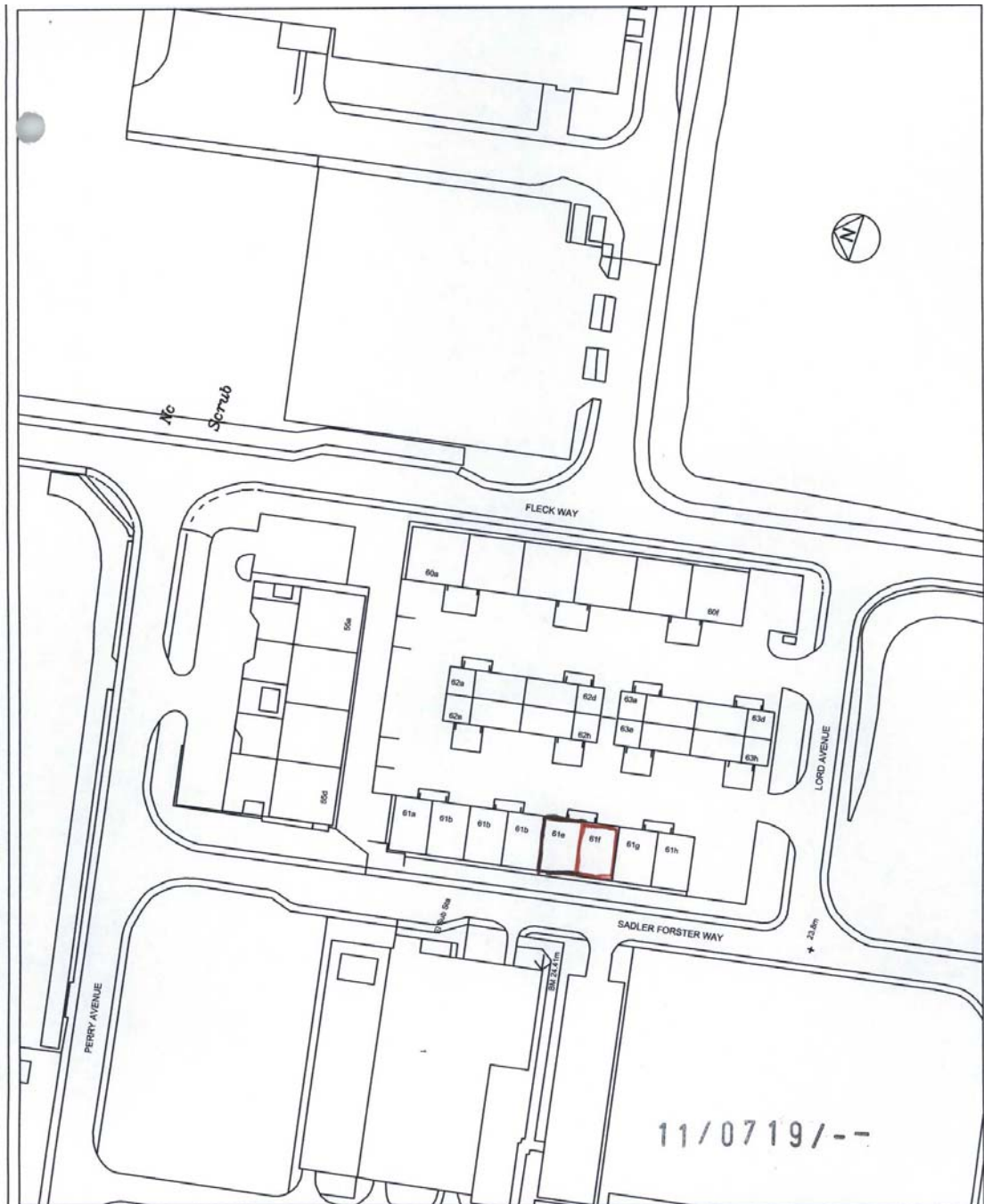

BUILDINGS FOR BUSINESS

DRAWING No BT50/61E/RDA/AJH/280405

SCALE 1 : 1250

DATE 28th April 2005

Appendix 2- EXISTING FLOOR PLAN

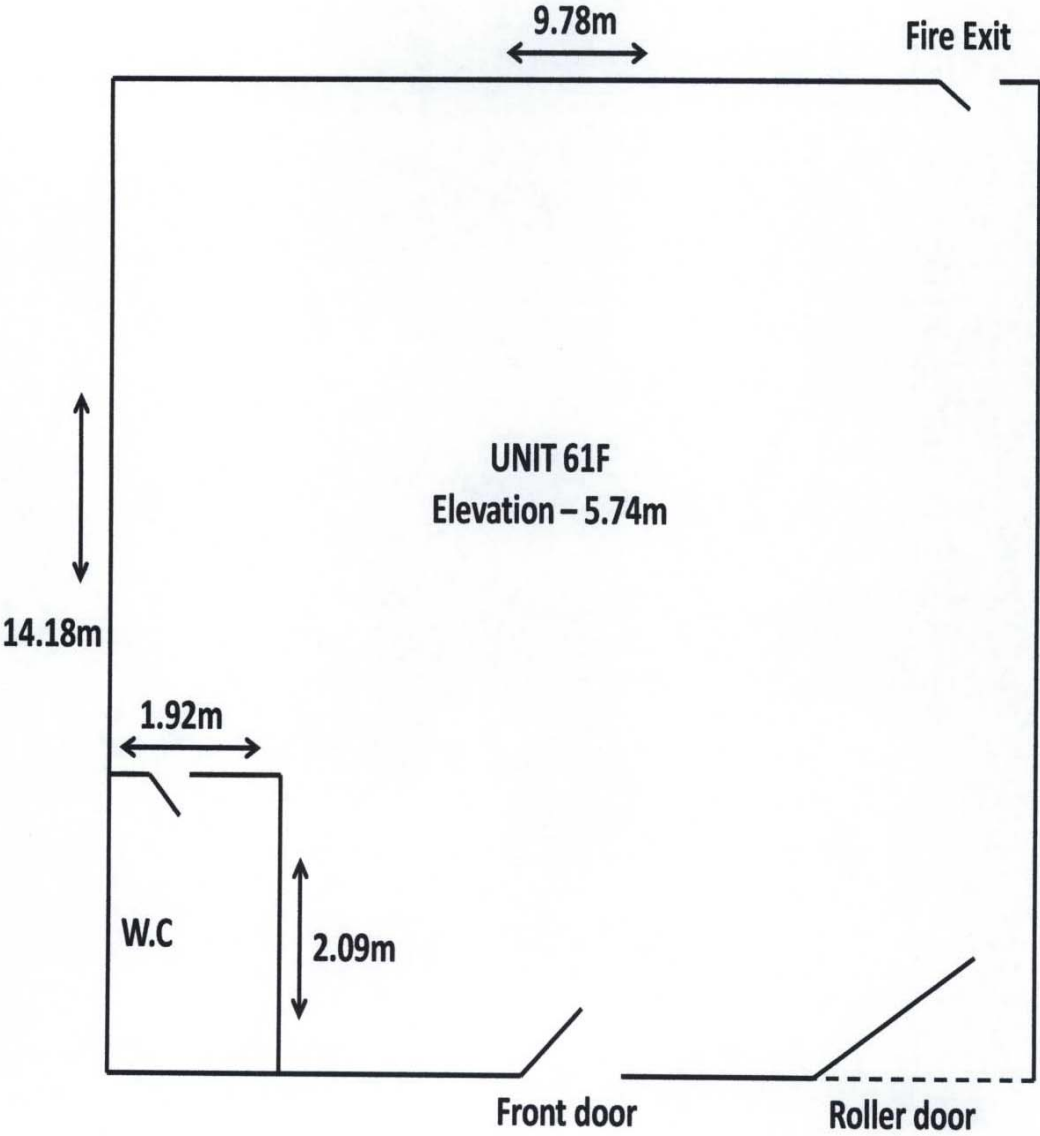

Appendix 3- PROPOSED FLOOR PLAN

No change to the original dimensions

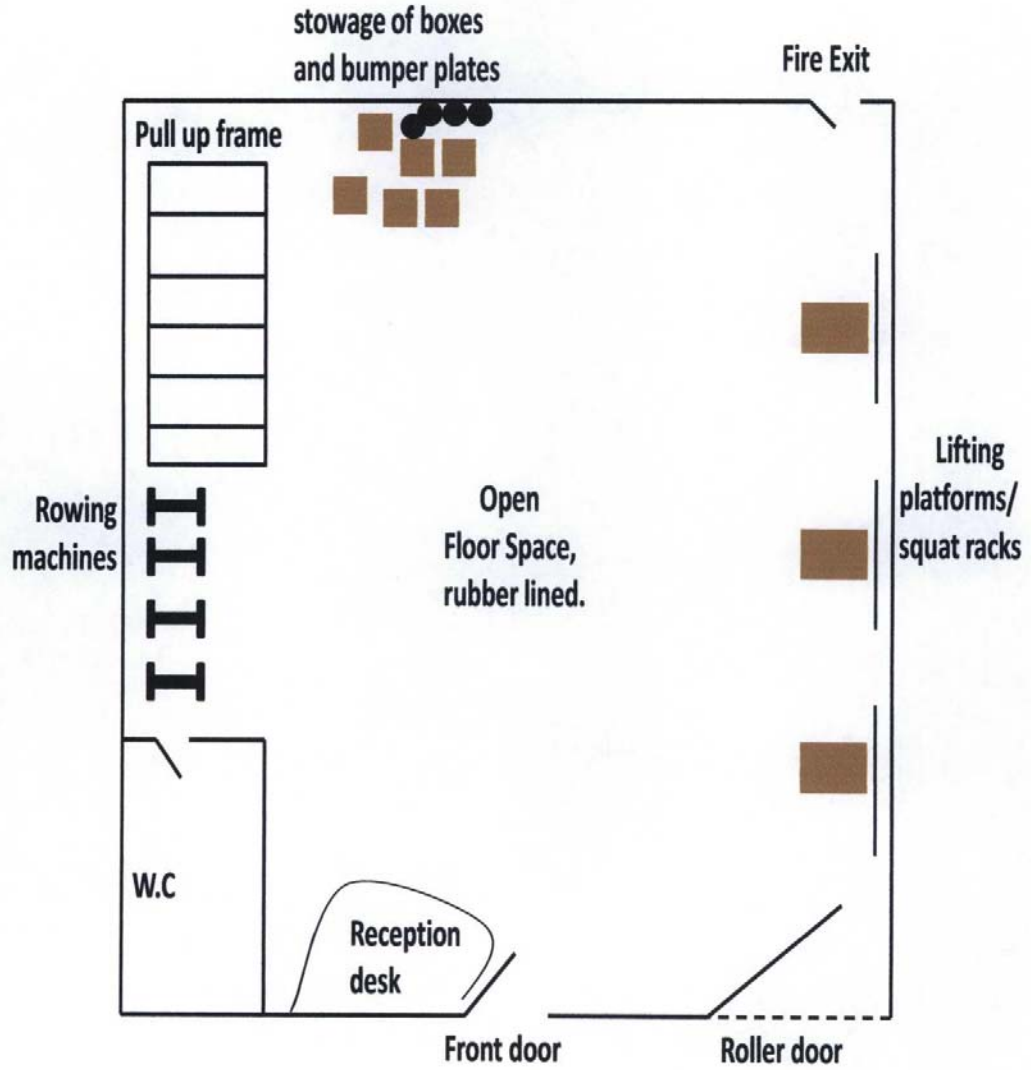

Appendix 4- CAR PARKING PROVISION

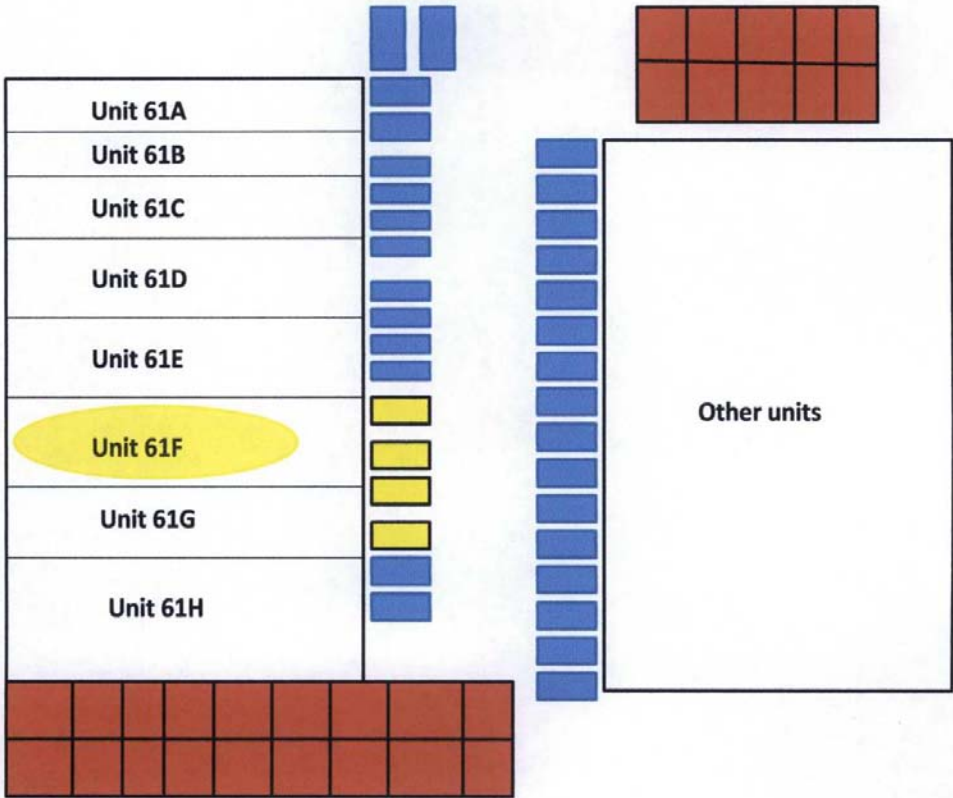

Key

- = Overflow spaces
- = Other unit spaces
- = 61F allocated spaces

There are 4 spaces allocated to unit 61F; however the overflow car park has a further 28 spaces. The spaces belonging to the other units should be available to use as Crossfit Teesside will run during off peak times.